

H41H H41W H41N

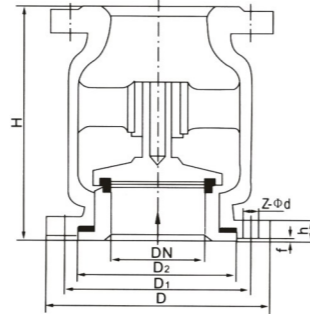

H42H H42W H42N

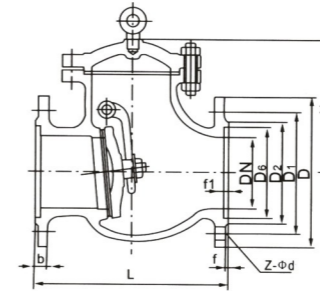

■ 主要性能规范 Chief property and specification

试验压力(MPa) Test pressure	公称压力PN Nominal pressure			
	2.5	2.5	6.4	10
壳体试验压力PT Shell test	3.75	6.0	9.6	15
密封试验(液) Seal test(Liquid)	2.75	4.4	7.0	11
密封试验(气) Seal test(gas)	0.6			
适用介质 Applicable medium	C	P	R	
	水、油品、蒸汽 Water,Oil,Steam	硝酸类 Nitric Acid	醋酸类 Acetic Acid	
适用温度 Applicable temperature	≤425℃	≤200℃	≤200℃	

- 1、设计与制造Design manufacture according: GB/T 12235-89
- 3、法兰标准Flange standard: JB/T 79-94
- 4、阀门压力试验: GB/T 13927-92

■ 主要连接及外形尺寸 Main connection and external dimensions (mm)

PN	DN	L	H	D	D ₁	D ₂	D ₆	b	f	f ₁	z-φd
H41 ^H _W ^N -25 ^C _R	15	130	100	95	65	45	-	16	2	-	4-φ14
	20	150	105	105	75	55	-	16	2	-	4-φ14
	25	160	120	115	85	65	-	16	2	-	4-φ14
	32	180	130	135	100	78	-	18	2	-	4-φ18
	40	200	135	145	110	85	-	18	3	-	4-φ18
	50	230	149	160	125	100	-	20	3	-	4-φ18
	80	310	169	195	160	135	-	22	3	-	8-φ18
	100	350	194	230	190	160	-	24	3	-	8-φ23
	150	480	255	300	250	218	-	30	3	-	8-φ25
	200	600	305	360	310	278	-	34	3	-	12-φ25
H41 ^H _W ^N -40 ^C _R	15	130	100	95	65	45	40	16	2	4	4-φ14
	20	150	105	105	75	55	51	16	2	4	4-φ14
	25	160	120	115	85	65	58	16	2	4	4-φ14
	32	180	130	135	100	78	66	18	2	4	4-φ18
	40	200	135	145	110	85	76	18	3	4	4-φ18
	50	230	149	160	125	100	88	20	3	4	4-φ18
	80	310	169	195	160	135	121	22	3	4	8-φ18
	100	350	194	230	190	160	150	24	3	4.5	8-φ23
	150	480	255	300	250	218	204	30	3	4.5	8-φ25
	200	600	305	375	320	282	260	38	3	4.5	12-φ30
H41 ^H _W ^N -64 ^C _R	15	130	100	105	75	55	40	18	2	4	4-φ14
	20	150	110	125	90	68	51	20	2	4	4-φ18
	25	160	125	135	100	78	58	22	2	4	4-φ18
	32	180	140	150	110	82	66	24	2	4	4-φ23
	40	200	168	165	125	95	76	24	3	4	4-φ23
	50	230	170	175	135	105	88	26	3	4	4-φ23
	80	310	205	210	170	140	121	30	3	4	8-φ23
	100	350	230	250	200	168	150	32	3	4.5	8-φ25
	150	480	265	340	280	240	204	38	3	4.5	8-φ34
	200	600	310	405	345	300	260	44	3	4.5	12-φ34

■ 性能规范 Specifications

公称压力PN Nominal pressure	2.5	4.0	6.4	10.0	MPa
壳体试验压力PT Shell test	3.75	6.0	9.6	15.0	
高压密封试验压力 High pressure sealing test	2.75	4.0	7.04	11.0	
低压密封试验压力 Low pressure sealing test	0.6				
适用介质 Applicable medium	C	P	R	N	
	水、油品、蒸汽 Water,Oil,Steam	硝酸类 Nitric Acid	醋酸类 Acetic Acid	液化气 LPG	
适用温度 Applicable temperature	≤425℃	≤100℃		-40~+80℃	

- 1、设计与制造Design manufacture according: GB/T 12235-89
- 2、结构长度Face to face: GB/T 12221-89
- 3、法兰标准Flange standard: JB/T 79-94
- 4、阀门检查和试验Valve check and test according: GB/T 13927-92

■ 主要连接及外形尺寸 Main connection and external dimensions (mm)

PN	DN	H	D	D ₁	D ₂	b	f	z-φd
H42 ^H _N ^Y -25 ^C _R	32	120	135	100	78	18	2	4-φ18
	40	130	145	110	85	18	3	4-φ18
	50	140	160	125	100	20	3	4-φ18
	65	160	180	145	120	22	3	8-φ18
	80	185	195	160	135	22	3	8-φ18
	100	210	230	190	160	24	3	8-φ23
	125	250	270	220	188	28	3	8-φ25
	150	300	300	250	218	30	3	8-φ25
	200	380	360	310	278	34	3	12-φ25

■ 主要连接及外形尺寸 Main connection and external dimensions (mm)

公称压力PN(MPa) Nominal pressure	公称口径DN(mm) Nominal diameter	L	H	D	D ₁	D ₂	D ₆	b	f	f ₂	z-φd
H44 ^H _W ^Y -25 ^C _R	50	230	160	160	125	100	-	20	3	-	4-φ18
	65	290	175	180	145	120	-	22	3	-	8-φ18
	80	310	185	195	160	135	-	22	3	-	8-φ18
	100	350	220	230	190	160	-	24	3	-	8-φ23
	125	400	248	270	220	188	-	28	3	-	8-φ25
	150	480	276	300	250	218	-	30	3	-	8-φ25
	200	550	350	360	310	278	-	34	3	-	12-φ25
	250	650	410	425	370	332	-	36	3	-	12-φ30
	300	750	430	485	430	390	-	40	4	-	16-φ30
	350	850	518	550	490	448	-	44	4	-	16-φ34
H44 ^H _W ^Y -40 ^C _R	400	950	560	610	550	505	-	48	4	-	16-φ34
	500	1150	618	730	660	610	-	52	4	-	20-φ41
	50	230	169	160	125	100	88	20	3	4	4-φ18
	65	290	173	180	145	120	110	22	3	4	8-φ18
	80	310	185	195	160	135	121	22	3	4	8-φ18
	100	350	220	230	190	160	150	24	3	4.5	8-φ23
	125	400	248	270	220	188	176	28	3	4.5	8-φ25
	150	480	270	300	250	218	204	30	3	4.5	8-φ25
	200	550	342	375	320	282	260	38	3	4.5	12-φ30
	250	650	401	445	385	345	313	42	3	4.5	12-φ34
H44 ^H _W ^Y -64 ^C _R	300	750	423	510	450	408	364	46	4	4.5	16-φ34
	350	850	455	570	510	465	422	52	4	5	16-φ34
	400	950	510	655	585	535	474	58	4	5	16-φ41
	50	300	177	175	135	105	88	26	3	4	4-φ23
	65	340	197	200	160	130	110	28	3	4	8-φ23
	80	380	212	210	170	140	121	30	3	4	8-φ23
	100	430	248	250	200	168	150	32	3	4.5	8-φ25
	125	500	296	295	240	202	176	36	3	4.5	8-φ30
	150	550	330	340	280	240	204	38	3	4.5	8-φ34
	200	650	385	405	345	300	260	44	3	4.5	12-φ34
H44 ^H _W ^Y -100 ^C _R	250	775	445	470	400	352	313	48	3	4.5	12-φ41
	300	900	474	530	460	412	364	54	4	4.5	16-φ41
	350	1025	514	595	525	475	422	60	4	5	16-φ41
	400	1150	616	670	585	525	474	66	4	5	16-φ48
	50	300	210	195	145	112	88	28	3	4	8-φ25
	65	340	227	220	170	138	110	32	3	4	8-φ25
	80	380	235	230	180	148	121	34	3	4	8-φ25
	100	430	274	265	210	172	150	38	3	4.5	8-φ30
	150	550	340	350	290	250	204	46	3	4.5	12-φ34
	200	650	374	430	360	312	260	54	3	4.5	12-φ41
H44 ^H _W ^Y -100 ^C _R	250	775	440	500	430	382	313	60	3	4.5	12-φ41
	300	900	505	585	500	442	364	70	4	4.5	16-φ48

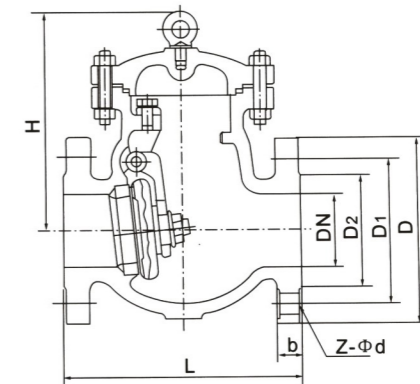
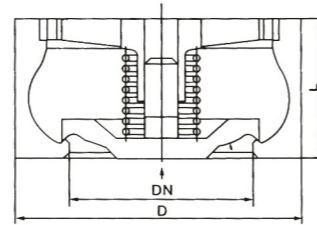
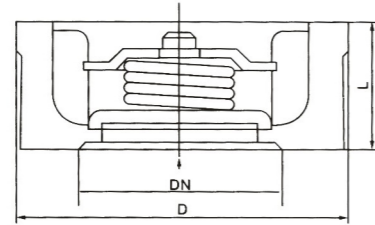

性能规范 Specifications

公称压力PN(MPa) Nominal pressure	1.0	1.6	2.5	4.0
强度试验(水) Strength test(water)	1.5	2.4	2.75	6.0
高压密封试验(水) Hight seal test(water)	1.1	17.8	38.5	44
产品型号Type	H71HWY-10.16.25.40CPR	H71HWY-10.16.25.40CPR	H71HWY-10.16.25.40CPR	
材料代号Material code	C	P	R	
适用介质 Applicable medium	水、蒸汽、空气、油品等Water,Steam,Air,Oil	硝酸类 Nitric Acid	醋酸类 Aceticacid	
适用温度 Applicable temperature	≤425℃	≤200℃	≤200℃	

该止回阀是本公司引进国外技术的其中之一产品。该产品采用了抗耐磨性，良好的合金材料作为密封主材，同时克服了管路介质压力低也能逆止的可靠性，该产品广泛应用于电力、石油、化工、冶炼等行业，产品深受用户好评。

This kind of check valve is among the products that introduced the advanced foreign technologies. This product adopts the abrasion proof alloy of good quality as the main sealing material and reduces the possibility that the pipe medium will check in low-pressure conditions. Popular among users, the product is widely used in industries of electric power, petroleum, chemical and refining.

主要连接及外形尺寸 Main connection and external dimensions

(mm)

公称压力PN(MPa) Nominal Pressure	公称通径(DN) Nominal diameter	L	D				重量(kg) Weight
			1.0MPa	1.6MPa	2.5MPa	4.0MPa	
H71 _P ^C -10	15	25	48	48	48	48	0.3
	20	31.5	58	58	58	58	0.5
	25	35.5	68	68	68	68	0.8
	32	40	78	80	80	80	1.3
	40	45	90	90	90	90	1.6
	50	56	96	96	105	105	2.3
H71 _P ^C -16	65	63	125	125	125	125	3.3
	80	71	143	143	143	143	4.4
H71 _P ^C -25	100	80	153	153	165	165	5.6
	125	110	194	194	194	194	9.2
H71 _P ^C -40	150	125	218	218	225	225	12.5
	200	160	274	274	285	290	16.5
	250	200	327	330	340	350	20
	300	250	377	385	400	415	27

应用规范

- 设计制造按BS 1868、JIS B2071
- 结构长度
ANSI150~2500Lb按ANSI B16.10
JIS10/20K按JIS B2001
- 连接法兰
ANSI150~2500Lb按ANSI B16.5
JIS10/20K按JIS B2212、B2214
- 阀门检查和试验按API 598

结构

B.B, 旋启式

主体材料

WCB、WC6、WC9、CF8、CF8M、CF3、CF3M

主要连接及外形尺寸 Main connection and external dimensions

公称压力PN(Lb) Nominal Pressure	公称通径NPS Nominal diameter		d	L	D	D ₁	D ₂	b	H ₁	Z-φd
	in	mm								
150	11/2	40	38	165	127	98.5	73	15	154	4-Φ15
	2	50	51	203	152	120.5	92	16	175	4-Φ19
	21/2	65	64	216	178	139.5	105	18	177	4-Φ19
	3	80	76	241	190	152.5	127	19	191	4-Φ19
	4	100	102	292	229	190.5	157	24	222	8-Φ19
	6	150	152	356	279	241.5	216	26	325	8-Φ22
	8	200	203	495	343	298.5	270	29	383	8-Φ22
	10	250	254	622	406	362	324	31	448	12-Φ25
	12	300	305	698	483	432	381	32	540	12-Φ25
	14	350	357	787	533	476	413	35	560	12-Φ29
300	11/2	40	38	241	156	114.3	73	21	172	4-Φ22
	2	50	51	267	165	127	92	23	198	8-Φ19
	21/2	65	64	292	190	149	105	26	204	8-Φ22
	3	80	76	318	210	168.3	127	29	222	8-Φ22
	4	100	102	356	254	200	157	32	277	8-Φ22
	6	150	152	444	318	269.9	216	37	346	12-Φ22
	8	200	203	533	381	330	270	42	412	12-Φ25
	10	250	254	622	445	387.5	324	48	465	16-Φ29
	12	300	305	711	521	451	381	51	562	16-Φ32

Specification

- Design and manufacture comply with BS 1868, JIS B2071
- Face to face dimension comply
ANSI150~2500Lb按ANSI B16.10
JIS10/20K按JIS B2001
- Connection flange
ANSI150~2500Lb按ANSI B16.5
JIS10/20K按JIS B2212、B2214
- Test and inspection acc to API 598

Construction

B.B, Swing Type

Main Material

WCB、WC6、WC9、CF8、CF8M、CF3、CF3M

■ 结构特点及用途 Structures characteristics and usahe

该阀采用对夹式安装，主要用于管路中或水泵出口处，用于水泵停机时防止管路中介质倒流，压差水锤冲击水泵倒转的安全装置。本阀具有体积小、重量轻、便于安装维修，有导向装置，关闭灵活、快速，防止巨大介质倒流压差，形成消声效果。

适用于给排水、消防、暖通等管路或泵出口，以防止介质倒流水锤冲击对管路及泵的损害。

This valve uses butt-installation and is used in the pipeline or at the pump outlet to, as a safety device, prevent the pump from inversed running due to the differential water hammer's shock caused by the medium's back-flow in the pipeline when the pump stops, and features small volume, light weight, easy in-stallation and maintenance, set with a guide device, flexible and quick close, preventing huge medium's back-flow differential and forming silencing effect.

Suitable for the pipeline of water supply and drainage, fire-fighting, warming etc. Or the pump outlet to prevent both pump and pipeline from being damaged due to the medium's back-flow water hammer's shock.

■ 主要技术参数 Main technique number

型号 Type	公称 Nominal PN(MPa)	强度试验压力 Test stre- ngth pressure (MPa)	密封试验压力 Test seal Pressure (MPa)	适用温度 Applicable temperature (°C)	适用温度 Applicable Media
H76X-10 H77X-10	1.0	1.5	1.1	≤80	清水 Clean-water
H76X-16 H77X-16	1.6	2.4	1.76		污水 Slops 海水 Sea

■ 主要零件材料 Material for main parts

零件名称 Name of part	阀体 Body	阀瓣 Disc	阀杆 Stem	弹簧 Spring	阀座 Seat
材 质 Material	铸铁CI、 碳钢BowI-shaped steel、不锈钢 Stainless steel	铸铁CI、 碳钢BowI-shaped steel、不锈钢 Stainless steel	不锈钢 Stainless steel	不锈钢 Stainless steel	丁腈橡胶NBR 不锈钢Stainless steel

■ 主要外形尺寸 Main external dimensions

公称通径 Nominal diameter DN(mm)	L	H	D	
			1.0MPa	1.6MPa
50	43	60	105	105
65	46	73	124	124
80	64	89	142	142
100	64	110	162	162
125	70	141	192	192
150	76	168	218	218
200	89	219	272	273
250	114	273	328	328
300	114	324	378	384
350	127	356	438	444
400	140	418	489	495
450	152	457	540	555
500	152	526	594	616
600	178	626	695	734
700	229	672	810	804
800	241	778	916	910
900	241	878	1016	1010
1000	300	914	1124	1128

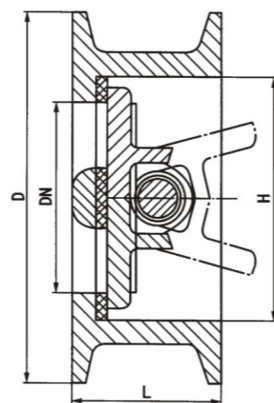

■ 结构特点及用途 Structures characteristics and usage

本阀是安装于管路中或水泵出口处用于泵停机时防止管路中压差水锤冲击水泵倒转的安全装置。具有结构新颖、体积小、重量轻、流体阻力小、密封可靠、启闭平稳、使用寿命长、有较好节能效果等特点。

适用于给排水、消防、暖通等系统的有关管路或泵出口处防止介质倒流所产生的水锤对泵与管路的损害，形成消声效果。

This valve is a safety device mounted in the pipeline or pump outlet to prevent the pump from inversed running due to the differential water hammer's shock in the pipeline when the pump stops and features a brand-new structure, small volume, light weight, small fluid resistance, reliable seal, stable open-close, long duration, better energy-saving effect.

Suitable for the pipeline related to water supply and drainage, fire-fighting, warming etc. Systems or the pump outlet to prevent both pump and pipeline from being damaged due to the water hammer produced when the medium flows back and form the silencing effect.

■ 主要技术参数 Main technique number

公称压力PN(mm) Nominal pressure	1.0	1.6	
试验压力 Test pressure (Mpa)	壳体强度 Shell strength	1.5	2.4
	密封性能 Sealing performance	1.1	1.76
工作温度(°C) Working temperature	≤80		
适用介质 Applicable medium	清水Clean-water、污水、海水Sea		
缓闭时间(S) Slow-close time	0-60		

■ 主要零件材料 Material for main partes

零件名称 Name of part	阀体 Body	阀瓣 Disc	阀杆Stem 油缸Oil oylinder 油塞Oil cork	弹簧 Spring	阀座 Seat
材 质 Material	铸铁CI、 碳钢BowI-shaped steel	碳钢BowI-shaped steel 不锈钢 Stainless steel	不锈钢 Stainless steel	不锈钢 Stainless steel	丁腈橡胶 NBR

■ 主要外形及连接尺寸 Main external and connecting dimensions

公称通径 Nominal diameter DN(mm)	公称压力 Nominal pressure DN(mm)	L	D	D ₁	D ₂	b	H	H ₁	n-Φd
50	10/16	160	165	125	100	20	105	110	4-18
65		170	185	145	120	20	110	115	4-18
80		180	200	160	135	22	115	120	4-18/8-18
100		190	220	180	158	24	130	228	8-18
150		210	285	240	212	26	172	230	8-23
200		230	340	295	268	28	210	270	8-23/12-23
250		250	395/405	350/355	320	28/30	240	305	12-23/12-25
300		270	445/460	400/470	370	28/30	264	367	12-23/12-25
350		290	505/520	460/470	430	30/34	294	422	16-23/16-25
400		310	565/580	515/525	482	32/36	324	462	16-25/16-30
450		330	615/640	565/585	532	32/40	351	497	20-25/20-30
500		350	670/715	620/650	585	34/44	379	532	20-25/20-34
600		390	780/840	725/770	685	36/48	434	607	20-30/20-37
700		430	895/910	840	800	40/50	491	702	24-30/24-37
800		470	1015/1025	950	905	44/52	549	792	24-34/24-41
900		510	1115/1125	1050	1005	46/54	600	900	28-34/28-41
1000	550	1230/1255	1160/1170	1110	50/56	655	975	28-34/28-45	
1200	630	1455/1485	1380/1390	1330	56/58	770	1140	32-41/32-51	

